



Beneficiar: TRITIANA SI TRITA MARIN
 Explicata tehnica in
 Raportul de verificare si
 Eng. M.



B. PUNCTE NOI DETERMINATE

| Coordonate | X | Y |
|------------|------------|----|
| 407502 412 | 315074 820 | 60 |
| 407502 417 | 315075 824 | 61 |
| 407504 764 | 315008 235 | 62 |
| 407504 764 | 315008 640 | 63 |
| 407504 764 | 315078 429 | 64 |
| 407504 764 | 315078 835 | 65 |
| 407504 764 | 315078 835 | 66 |
| 407504 764 | 315078 835 | 67 |
| 407504 764 | 315078 835 | 68 |
| 407504 764 | 315078 835 | 69 |

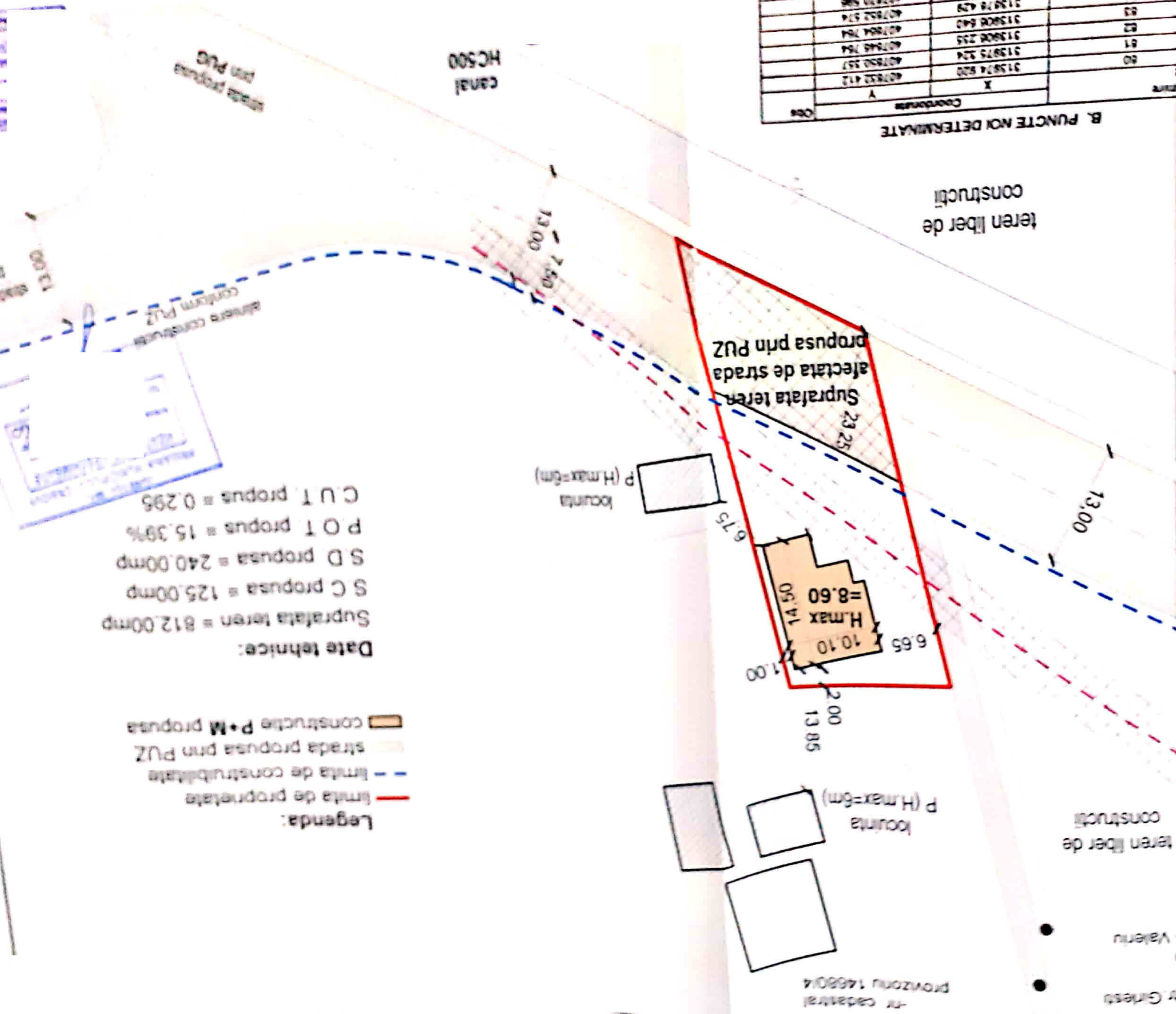

Date tehnice:
 Supratata teren = 812.00mp
 S C propusa = 125.00mp
 S D propusa = 240.00mp
 P O T propus = 15.39%
 C U T propus = 0.295

- Legenda:
- limita de proprietate
 - limita de constructibilitate
 - strada propusa prin PUZ
 - constructie P+M propusa

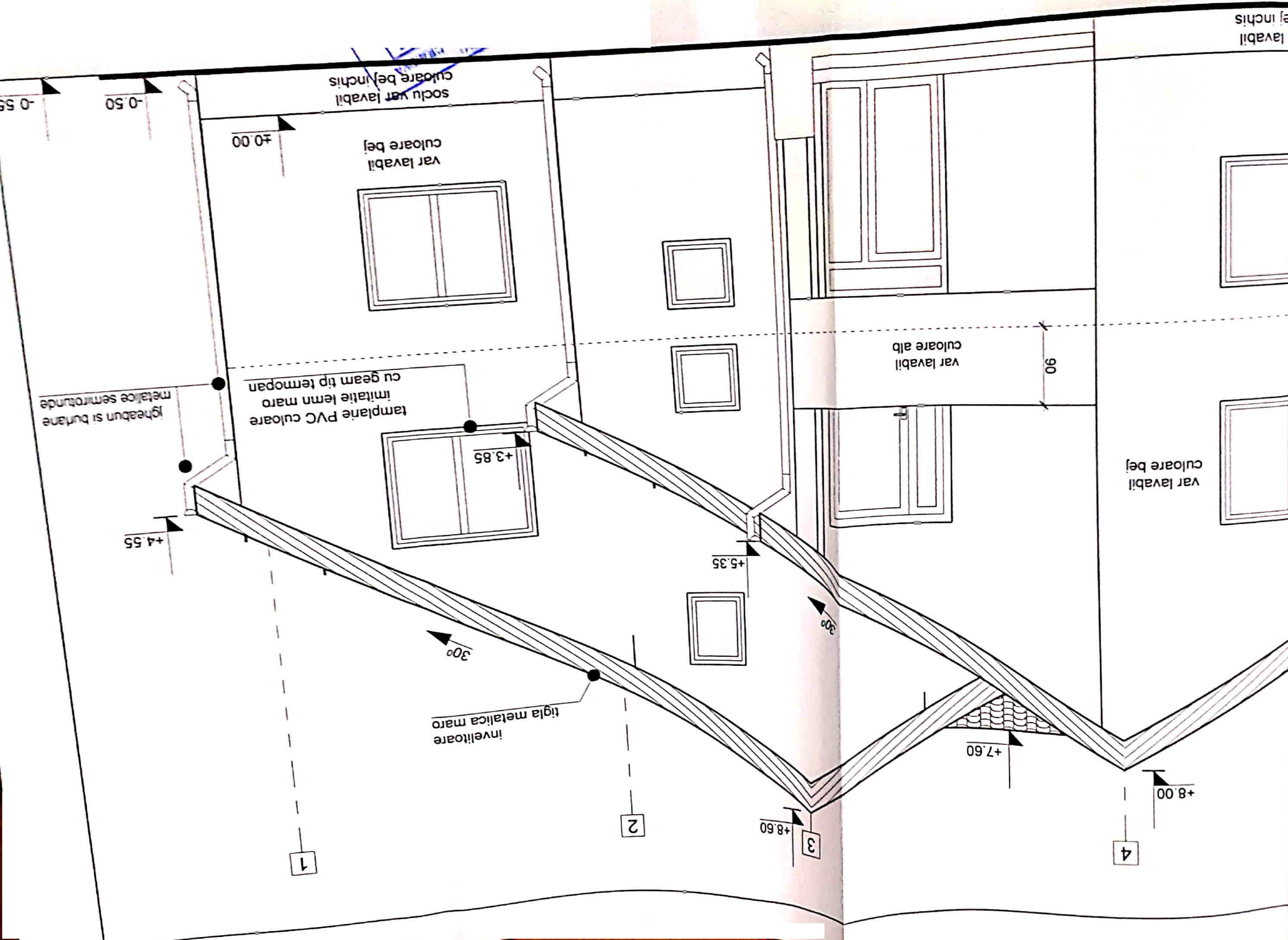

sotlu var lavabil
culoare bej/inchis

var lavabil
culoare bej

±0.00

-0.55

-0.50

igheabun si buran
metalice semirunde

tampelane PVC culoare
imitatie lemn maro
cu geam tip temopan

+3.85

+4.55

+5.35

invelitoare
tigla metalica maro

var lavabil
culoare alb

90

var lavabil
culoare bej

var lavabil
culoare bej/inchis

+7.60

+8.00

+8.60

1

2

3

4

C

B

A

+8.00

parazapaz
metalica

+5.35

igheaburi si burlane
metalice semirotunde

+2.85

var lavabil
culoare bej

tamplarie PVC culoare
imitatie lemn maro
cu geam tip termopan

±0.00

-0.45

-0.50

soclu var lavabil
culoare bej inchis

